



**10 Stansell Road**

Taunton, Somerset, TA1 3GG

**James  
Gray**

ESTATE AGENTS



A well presented semi-detached Summerfield built home, attractively situated on this sought after development with enclosed rear garden, garage and driveway parking for 2 cars

 3  1  2

### Key features

- Entrance Hall and cloakroom
- Sitting room
- Kitchen/dining room with doors to the rear garden
- Bedroom 1 with en suite shower room
- Two further bedrooms
- Family bath/shower room
- Gas central heating and double glazing
- Enclosed rear garden with paved terrace
- Detached garage and driveway parking
- Sought after Killams Park development on the southern fringe of Taunton

### Services

All mains services connected. Gas fired central heating

### EPC

Band B (84)

### Outgoings and Council Tax

Service charge £200 p.a. Council Tax Band C







GROUND FLOOR  
427 sq.ft. (39.7 sq.m.) approx.

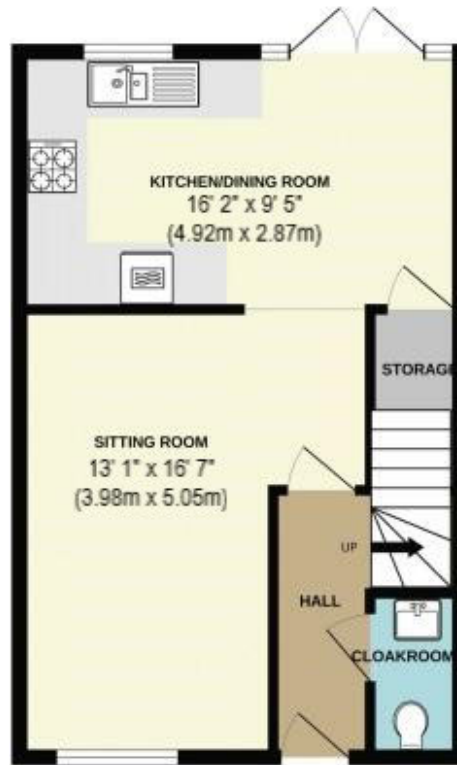

1ST FLOOR  
427 sq.ft. (39.7 sq.m.) approx.



TOTAL FLOOR AREA : 855 sq.ft. (79.4 sq.m.) approx.

While every attempt has been made to ensure the accuracy of the floorplan contained here, measurements of doors, windows, rooms and any other items are approximate and no responsibility is taken for any error, omission or mis-statement. This plan is for illustrative purposes only and should be used as such by any prospective purchaser. The services, systems and appliances shown have not been tested and no guarantee as to their operability or efficiency can be given.  
Made with Metropix ©2025

These particulars are not to form part of a Sale Contract owing to the possibility of errors and/or omissions. Prospective purchasers should therefore satisfy themselves by inspection or otherwise as to their correctness. All fixtures, fittings, chattels and other items not mentioned are specifically excluded unless otherwise agreed within the Sale Contract documentaries or left in situ and gratis upon completion. The property is also sold subject to rights of way, public footpaths, easements, wayleaves, covenants and any other matters which may affect the legal title. The Agent has not formally verified the property's structural integrity, ownership, tenure, acreages, estimated square footage, planning/building regulations status or the availability/operation of services and/or appliances. Therefore prospective purchasers are advised to seek validation of all the above matters prior to expressing any formal intent to purchase.

Home Field View North, Prockters Farm, West Monkton, Taunton, Somerset, TA2 8QN  
T: 01823 426 090 E: sales@jamesgrayestateagents.com W: jamesgrayestateagents.com

James  
Gray

ESTATE AGENTS